

**25-27 Childers Road MOUNT MACEDON VIC**

**2** **1**

FEATURING TOWERING EUROPEAN TREES,  
COLOURFUL HEDGING/PLANTINGS & GROUND  
COVER

**Building Size** : 14 sqm  
**Land Size** : 2727 sqm  
**View** : <https://www.kennedyandhunt.com.au/sale/vic/macedon-ranges/mount-macedon/residential/house/5848495>

Bright North facing 2 bedroom (easily converted to 3) red brick home with 2.7m ceilings and polished hardwood floors. Lovely garden views. 22,000 Lt rain water tank. Reverse cycle aircon. Very private setting opposite golf course. Planning approval for major extensions.



Outbuilding not in actual position to house.

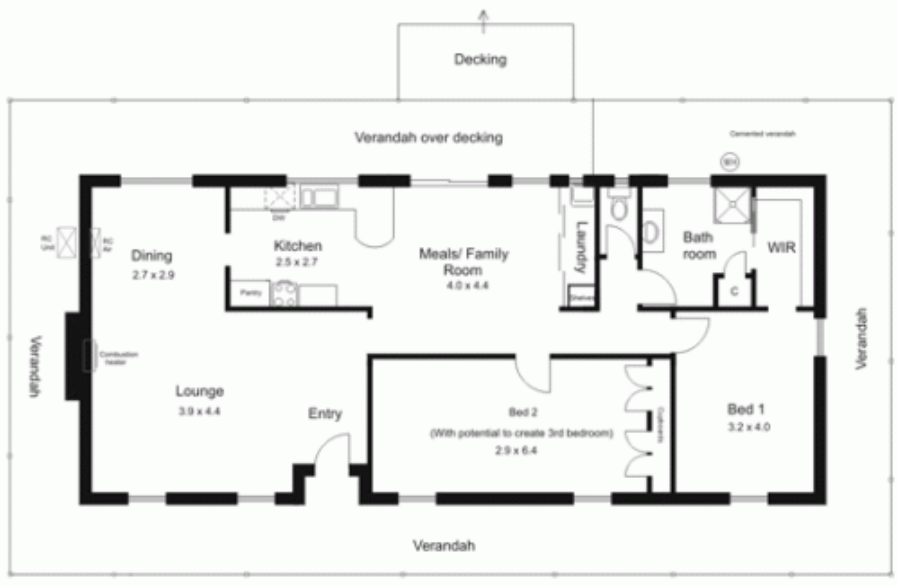

Drawing is for illustration purposes only. Not drawn to scale. All measurements are approximate only.