

5 Skyline Drive GISBORNE VIC

5 🏠 2 🚗 2 🚗

Five bedrooms all with great storage, two large living areas with fabulous views, contemporary hostess kitchen with the ultimate gas/electric range & granite benches, sleek bathroom and ensuite, double garage and much, much more! Landscaping includes mature shrubs and trees, stone paths and edgings, extensive decking, verandahs and undercover entertaining area. Perfect family design with flair and imagination

Price : \$ 650,000
Building Size : 28 sqm
Land Size : 2000 sqm
View : <https://www.kennedyandhunt.com.au/sale/vic/macedon-ranges/gisborne/residential/house/5848501>

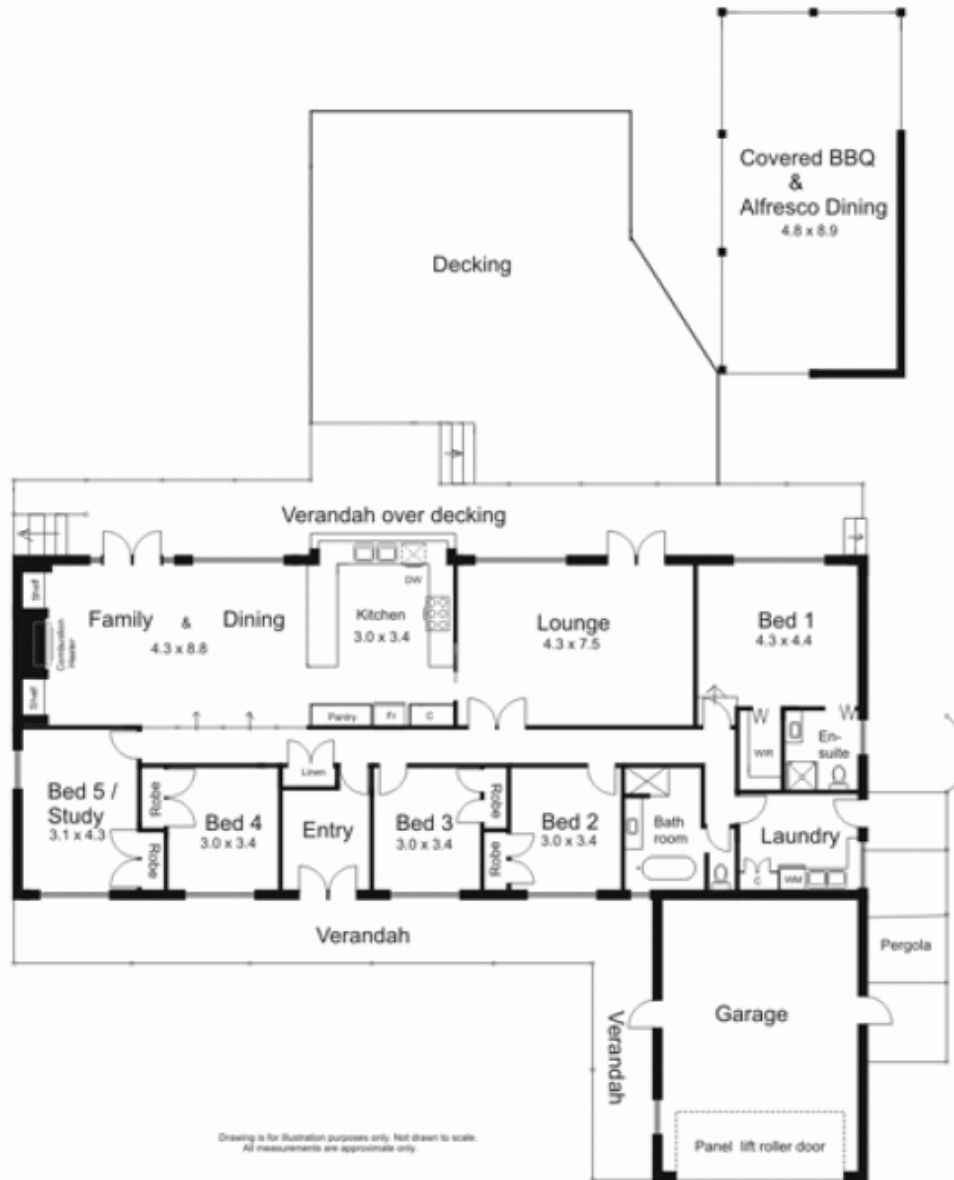

Drawing is for illustration purposes only. Not drawn to scale.
All measurements are approximate only.