



1/1 Melvins Road RIDDELLS CREEK VIC

2  **1**  **1** 

Comprises 2 bedrooms, entry hall, kitchen / meals / living with lovely garden aspect. Large rear garden and outdoor living. Full bathroom and separate laundry . Great location, walking distance to shops and station. Opposite parkland. Well presented and currently under lease. Good investment or purchase now for your future home.

Building Size : 9 sqm
View : <https://www.kennedyandhunt.com.au/sale/vic/macedon-ranges/riddells-creek/residential/unit/5848502>

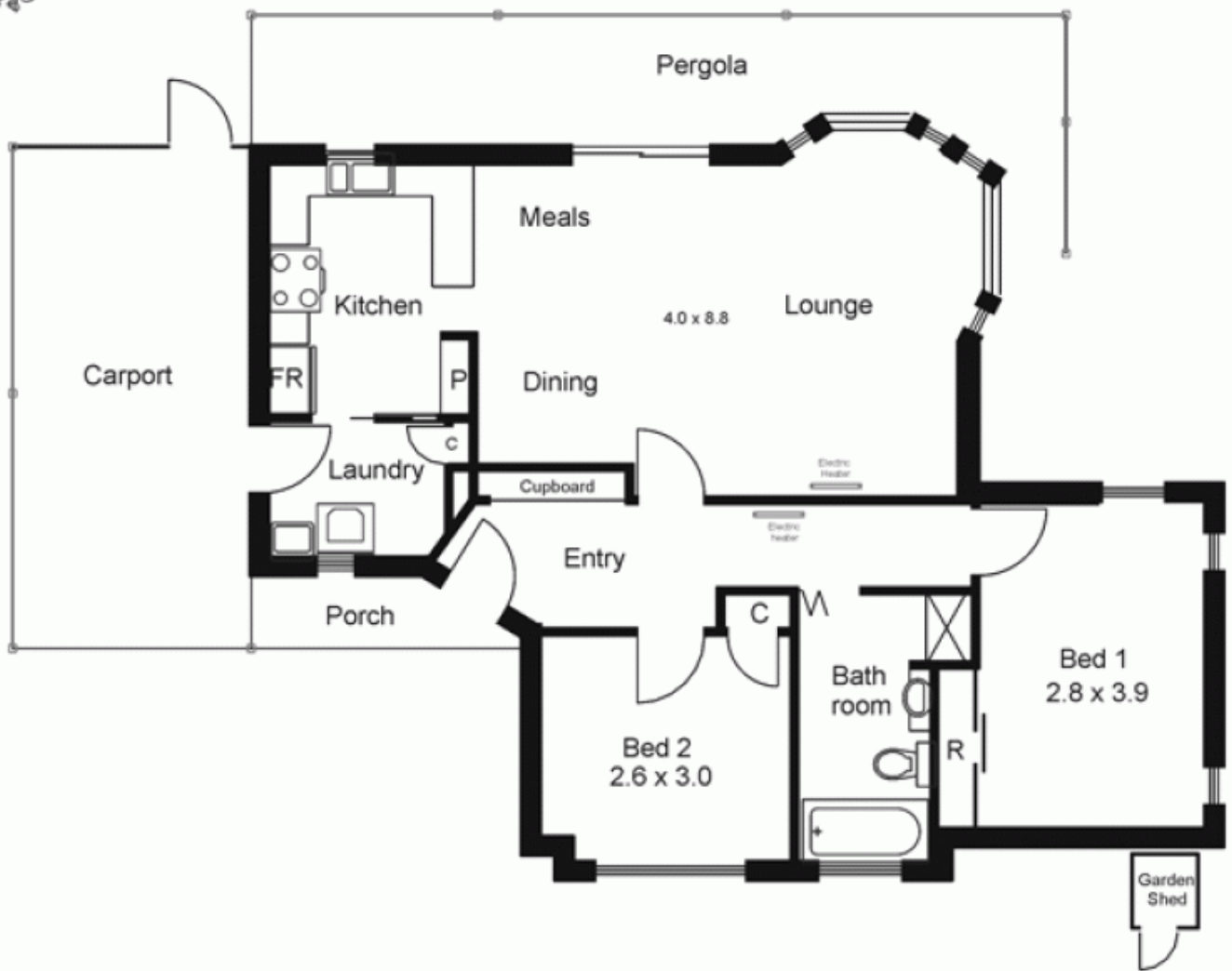
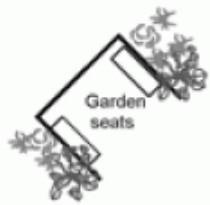

Drawing is for illustration purposes only.
All measurements are approximate only. Not drawn to scale.