



31 Swinburne Avenue GISBORNE VIC

5 2 4

Surrounded by wide protective verandas the home offers five large bedrooms, spacious formal lounge/dining room, 5m x 7m rumpus/billiard room, separate kitchen/meals area, main bathroom, ensuite and roomy laundry. Natural gas hydronic heating. Adjoining is a double carport and double garage/workshop and fully fenced in-ground solar heated swimming pool is there for the whole family to enjoy. Easy distance to main township, train station, schools and access to the freeway is a breeze. Country outlook with township convenience.

Building Size : 31 sqm
Land Size : 4000 sqm
View : <https://www.kennedyandhunt.com.au/sale/vic/macedon-ranges/gisborne/residential/house/5848514>

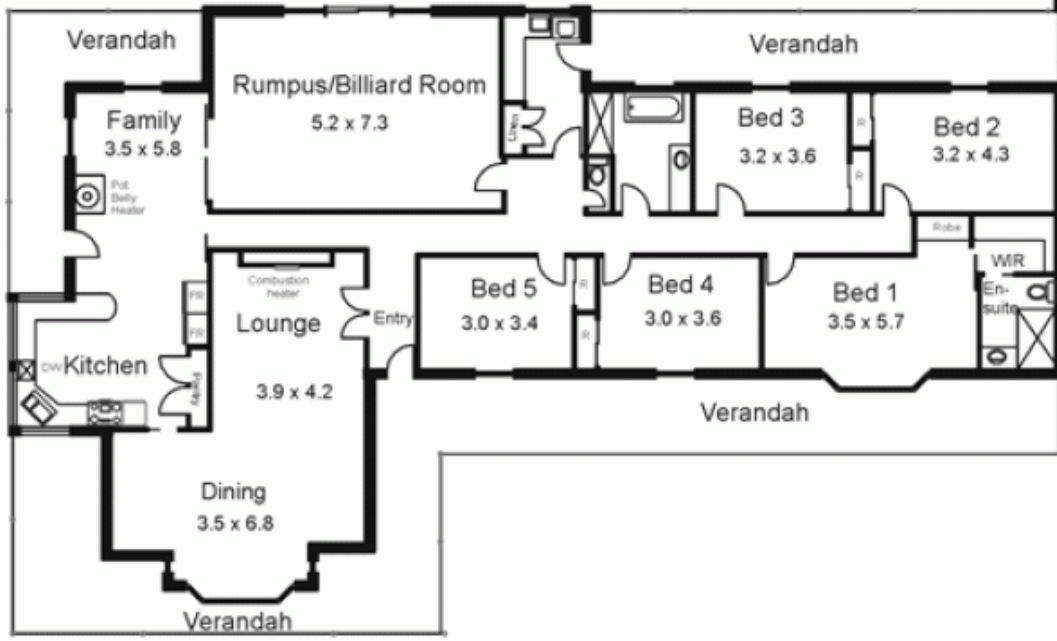
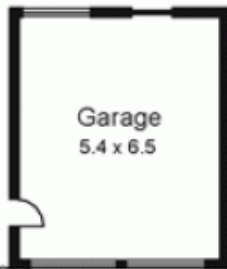
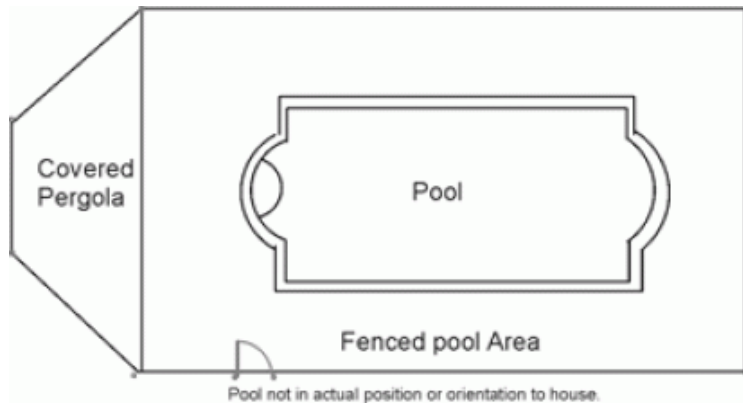

Drawing is for illustration purposes only. All measurements are approximate only. Not drawn to scale.