



147 Panorama Drive GISBORNE VIC

4 2 2

Impressive renovation emphasizes quality and style. Accommodation comprises four bedrooms, open plan central kitchen/meals/living space and separate formal step down lounge. Northern orientation overlooks the spectacular view, pool and manicured gardens. A distinctly different offering, be ready to be impressed!

Building Size : 21 sqm
Land Size : 5403 sqm
View : <https://www.kennedyandhunt.com.au/sale/vic/macedon-ranges/gisborne/residential/house/5848516>



Pool not in actual position to house.

- Legend
 RWT_rain water tank
 C_cupboard
 L_linen
 Dw_dishwasher
 Fr_Fridge
 P_Pantry



2 x 9,000 Litres

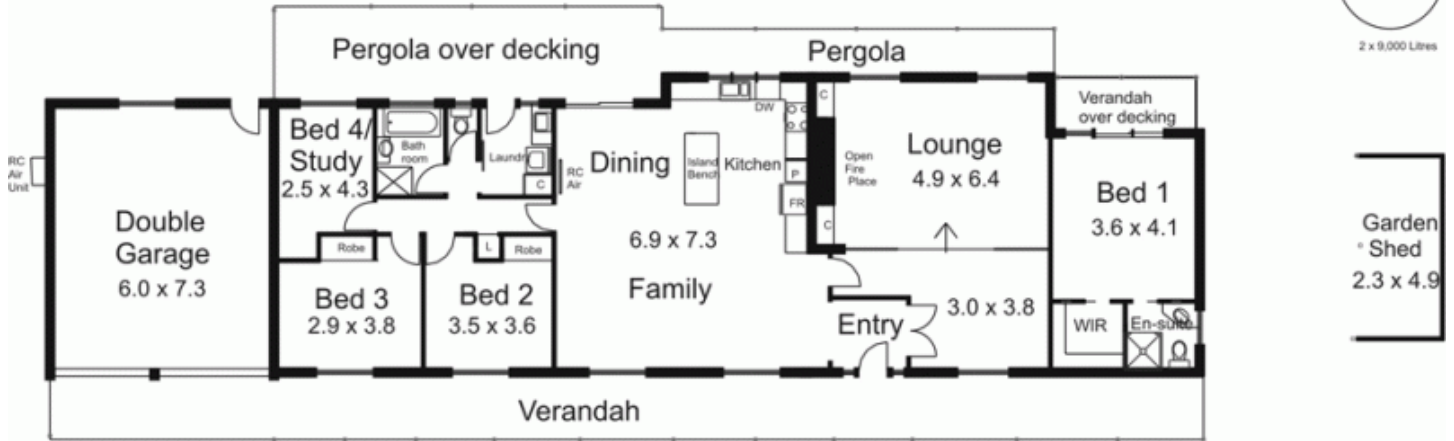

Drawing is for illustration purposes only. Not drawn to scale. All measurements are approximate only.