

38 Skyline Drive GISBORNE VIC

5 🏠 3 🚿 2 🚗

When space is a priority inside and out you will enjoy this property immensely! Grand staircase, five bedrooms (or four plus study), three bathrooms, powder room, two living areas and two beautiful winter-sun-filled garden rooms, plus fully integrated double garage and large garden shed. A complete, beautifully kept home. Features include granite bench tops, spa bath, top quality finishes and fittings, high ceilings and doors, and extensive paving. Parking space for caravan. A chance to upgrade your lifestyle!

Building Size : 30 sqm
Land Size : 2000 sqm
View : <https://www.kennedyandhunt.com.au/sale/vic/macedon-ranges/gisborne/residential/house/5848550>

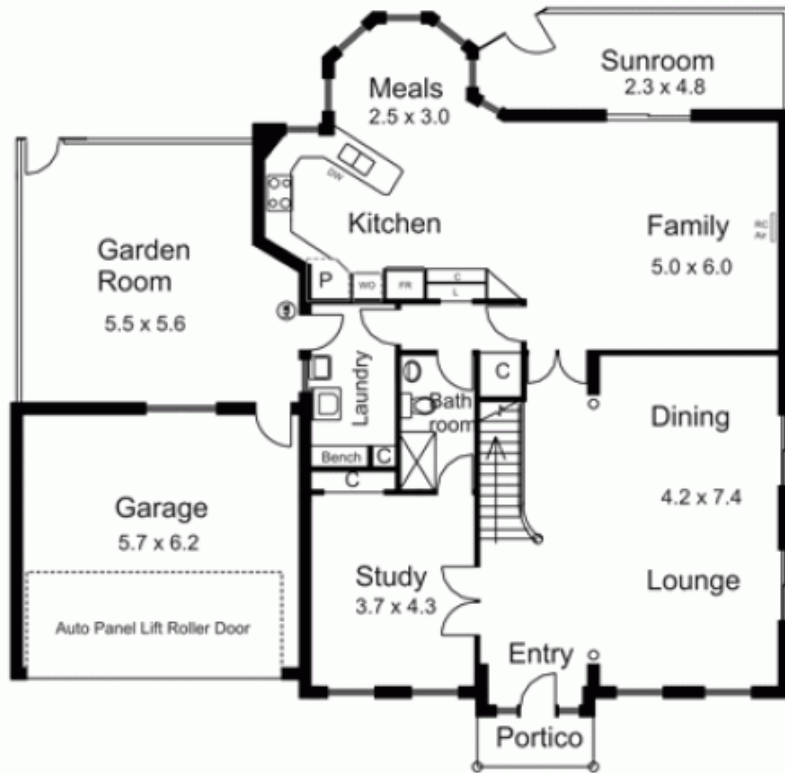

GROUND FLOOR

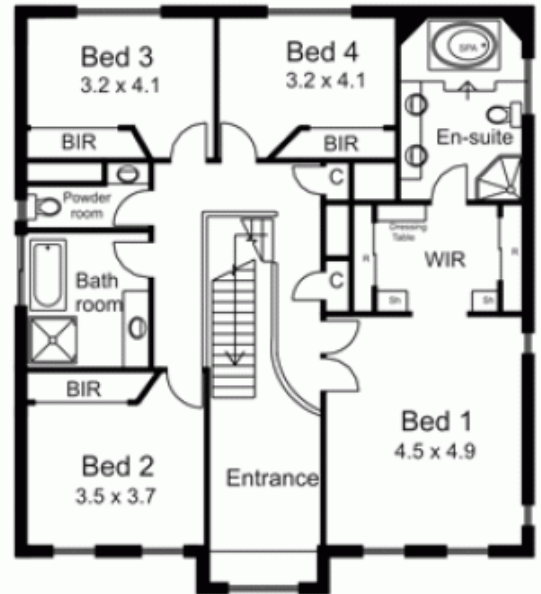

UPPER LEVEL

Drawing is for illustration purposes only. Not drawn to scale. All measurements are approximate only.