



**21 Lyell Street GISBORNE VIC**

4  2  2 

Delightful residential pocket in the heart of town. Accommodation comprises four bedrooms, ensuite, kitchen/meals and separate lounge. Features include modern kitchen, natural gas, polished floors, decking, double carport and brick garage to the rear. Take your living style to a new convenient level!

**Building Size** : 15 sqm  
**Land Size** : 602 sqm  
**View** : <https://www.kennedyandhunt.com.au/sale/vic/macedon-ranges/gisborne/residential/house/5848585>

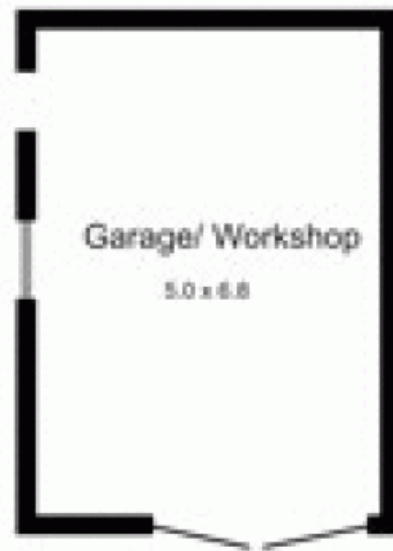

Garage not in actual position to house.

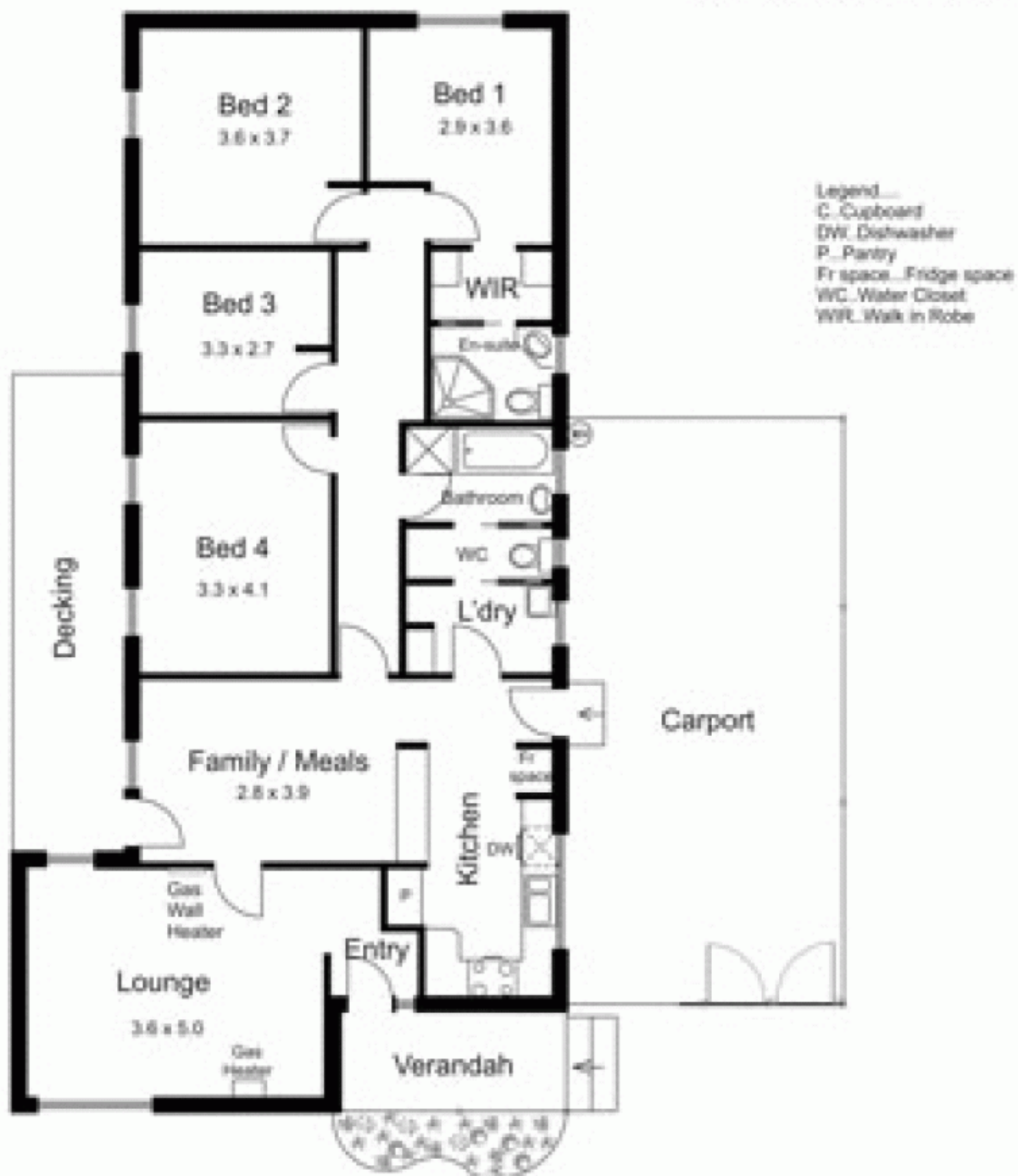

Drawing is for illustration purposes only. Not drawn to scale. All measurements are approximate only.