





3 The Willows GISBORNE VIC

4  2  4 

Building Size : 23 sqm
Land Size : 4016 sqm
View : <https://www.kennedyandhunt.com.au/sale/vic/macedon-ranges/gisborne/residential/house/5848608>

Self Contained Unit

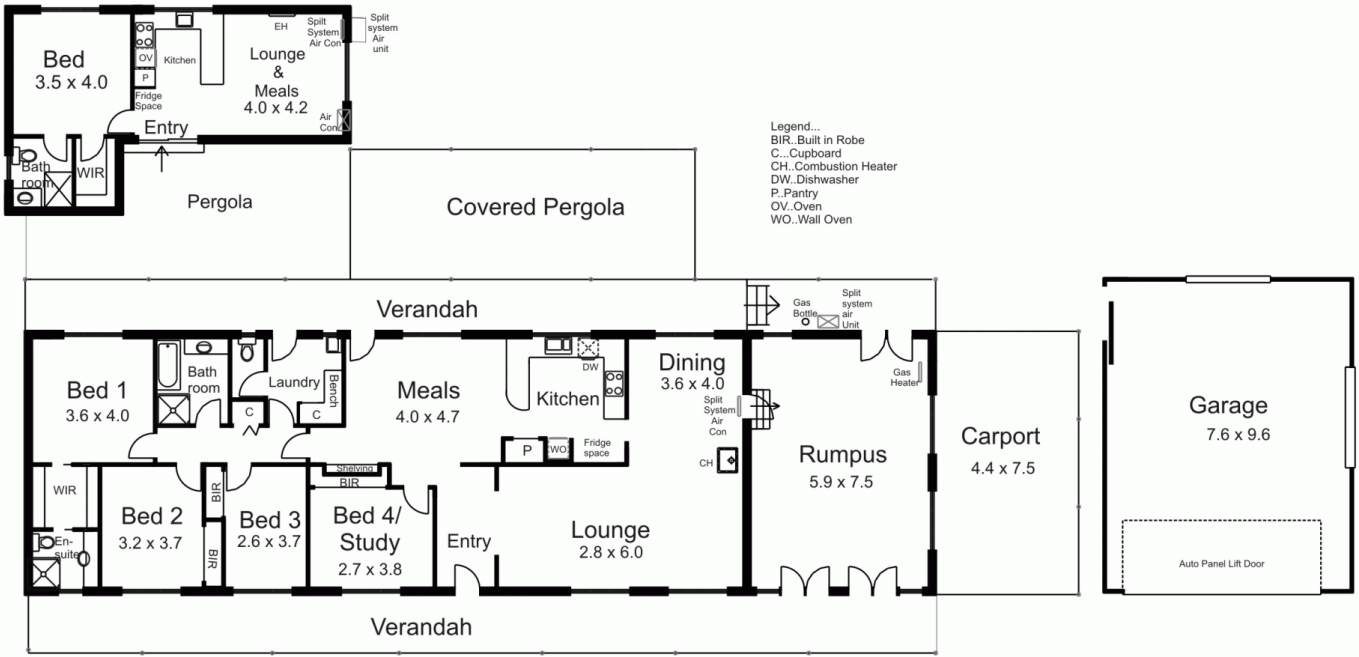

Drawing is for illustration purposes only. Not drawn to scale. All measurements are approximate only.