



**6 Thompson Close GISBORNE VIC**

3 2 2

Federation influenced home uses its charm to impress. User friendly floorplan consists of three bedrooms, Ensuite, lounge, study and expansive kitchen/meals/living area. This area opens to wonderful alfresco decking. The property has a practical rear yard along with the latest in Man land comforts! A comprehensive package that will be well received!

**Building Size** : 22 sqm  
**Land Size** : 948 sqm  
**View** : <https://www.kennedyandhunt.com.au/sale/vic/macedon-ranges/gisborne/residential/house/5848646>

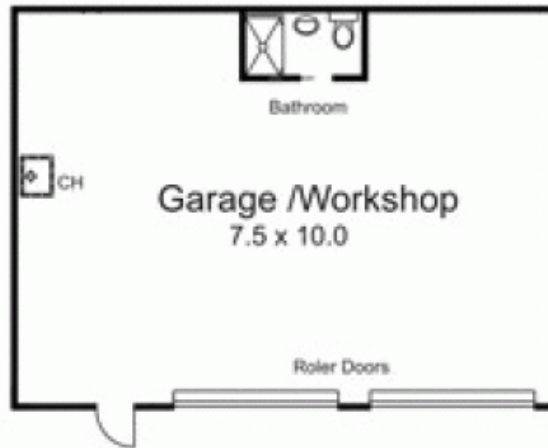

Garage / Workshop not in actual position to house.

Legend....  
 BIR..Built in Robe  
 CH..Combustion Heater  
 DW..Dishwasher  
 Fr Sp..Fridge Space  
 P..Pantry  
 WIR..Walk in Robe

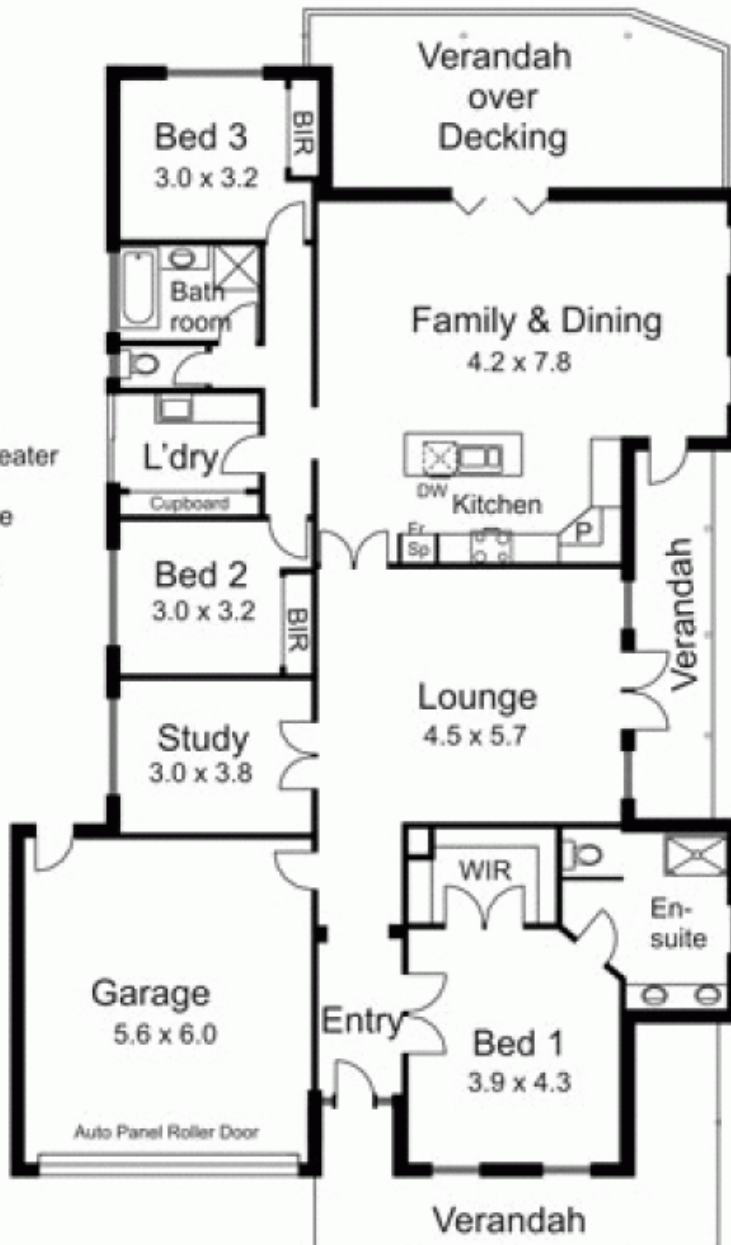

Drawing is for illustration purposes only. Not drawn to scale. All measurements are approximate only.