



102 Melton Road GISBORNE VIC

4 🏠 2 🚿 4 🚗

Yes, such a place does exist! Offers privacy, serenity, native wildlife, tennis court and self contained log cabin. Plus bright 4 bedroom brick veneer residence with two bathrooms & 2 living areas. Features brush box timber flooring and granite bench tops. Beautiful fenced lake with island, lilies and ducks. Easy walk to schools. Proposed Low Density Residential Zone.

Building Size : 21 sqm
Land Size : 16000 sqm
View : <https://www.kennedyandhunt.com.au/sale/vic/macedon-ranges/gisborne/residential/acreagesemirural/5848649>

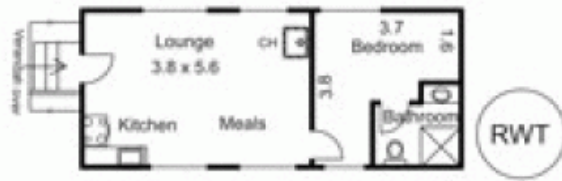

Log Cabin
Not in actual position to house

