



174 Campbell Road RIDDELLS CREEK VIC

4 🏠 2 🚿 4 🚗

What an opportunity to spread your wings and enjoy country living so close to the townships of Riddells Creek, Gisborne and Sunbury. Loads of room for many of the rural pursuits that we love. Perhaps a pony, livestock, chickens, extended vegetable garden or just tranquil space! Fantastic green features include solar power and water tanks. Its all ready to go for your new way of life!

Price : \$ 635,000
Building Size : 24 sqm
Land Size : 34700 sqm
View : <https://www.kennedyandhunt.com.au/sale/vic/macedon-ranges/riddells-creek/residential/acreagesemirural/5848682>

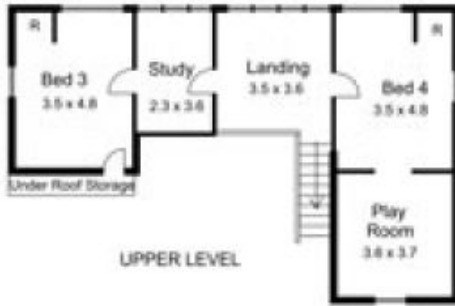

Drawing is for illustration purposes only. Not drawn to scale. All measurements are approximate only.