

8 Mt. Vista Close NEW GISBORNE VIC

4 2 2

Within easy distance to train station, primary schools and recreation reserve this property offers a great floor plan of four bedrooms, separate lounge, large kitchen/meals/family room, ensuite and family bathroom. Fully integrated double garage with remote controlled entry and rear roller door. Fittings include natural gas central heating, evaporative cooling, solar/gas hot water service and more. Add your own finishing touches to the landscaping and call this property home sweet home.

Building Size : 18 sqm
Land Size : 165 sqm
View : <https://www.kennedyandhunt.com.au/sale/vic/macedon-ranges/new-gisborne/residential/house/5848687>

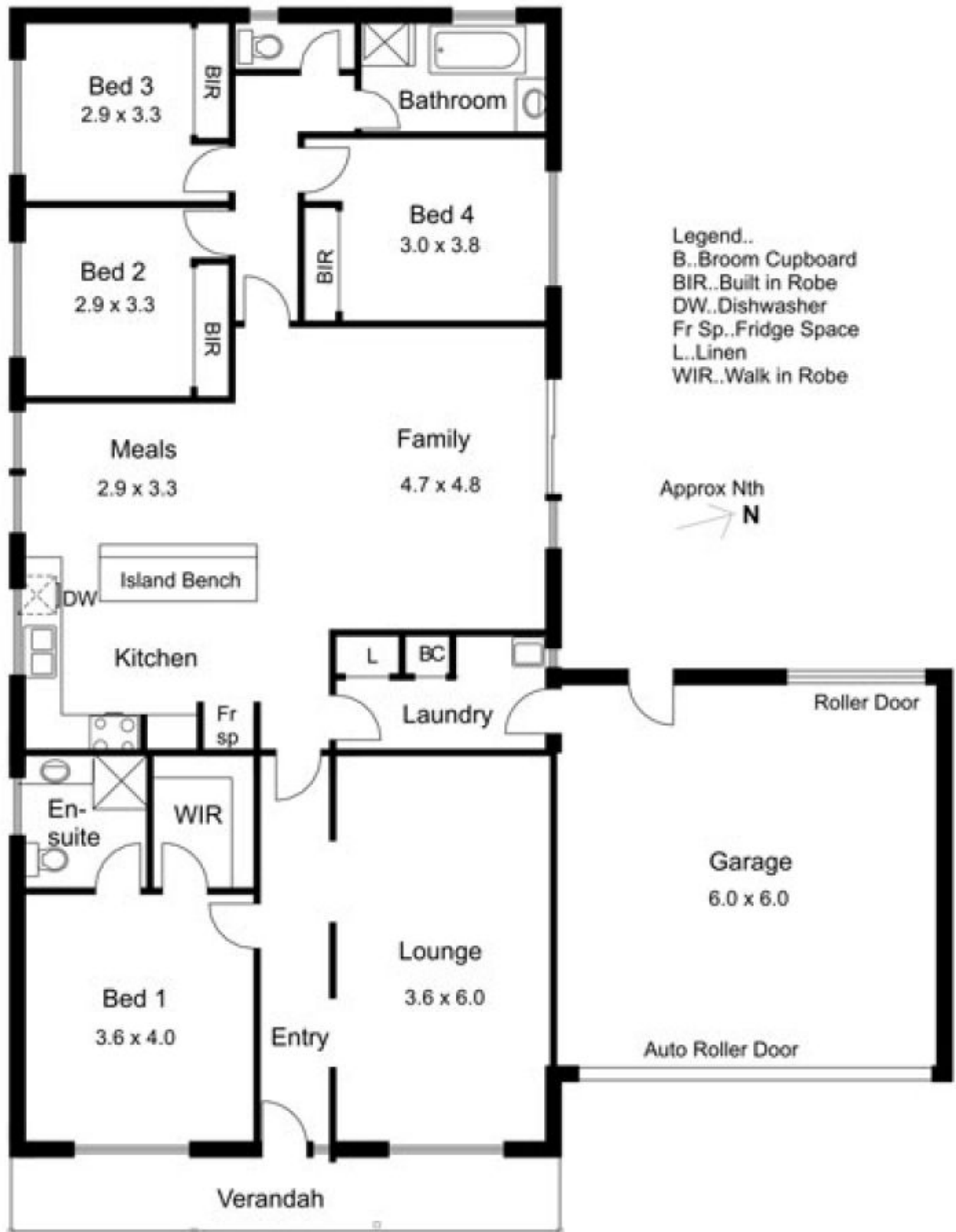

Drawing is for illustration purposes only. Not drawn to scale. All measurements are approximate only.