



**111 Shannons Road MOUNT MACEDON VIC**

5 🛏 2 🚿 2 🚗

Stylish country style limestone residence offering unsurpassed views to nearby Mount Macedon. Park like setting with mature trees / shrubs and pin oak lined driveway. Comprising 5 bedrooms and multiple living areas. Bright northerly aspect. Bonus studio / gym / home office. Garden allotment or suit grazing / vines etc. Gisborne Station approx. 5 minutes. Calder Freeway approx. 7 minutes.

**Building Size** : 30 sqm  
**Land Size** : 40000 sqm  
**View** : <https://www.kennedyandhunt.com.au/sale/vic/macedon-ranges/mount-macedon/residential/acreagesemirural/5848688>

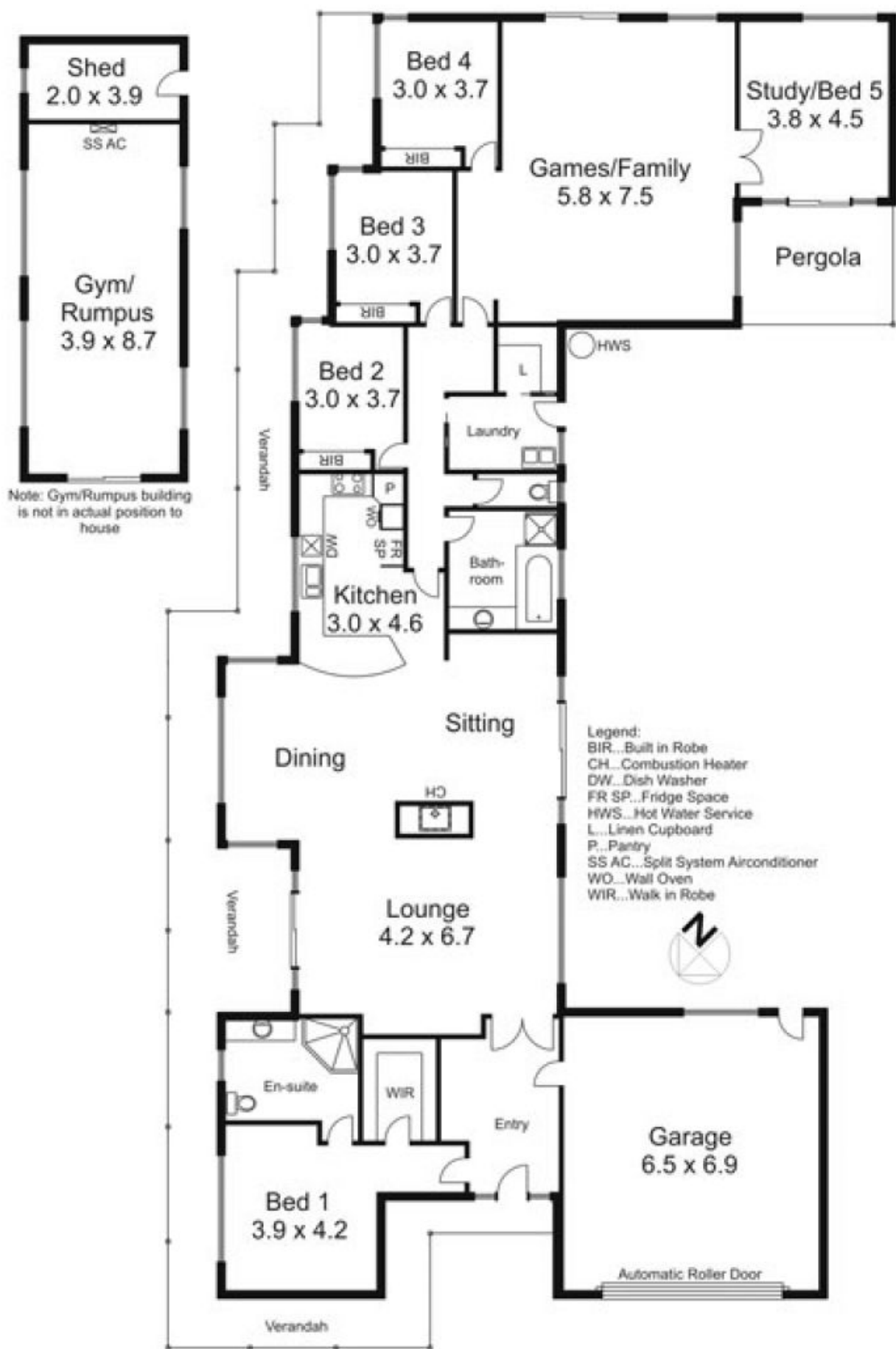

Note: Gym/Rumpus building is not in actual position to house

Drawing for illustration purposes only. Not drawn to scale. All measurements are approximate only.