



1366 Bacchus Marsh Road BULLENGAROOK VIC

3  **2**  **6** 

Comfortable homestead style residence offers 3 good sized bedrooms, ensuite, built in and walk in robes, study & formal entry. Two living areas enormous lounge & family room. Spacious kitchen, gas & wood heating. Double carport, large shed (7.6m x 12.2m approx.) and attached machinery shelter, paddocks for stock, 2 loose boxes, dams and ample rain water storage. Enjoy a rural lifestyle and still commute to work.

Building Size : 23 sqm
Land Size : 23000 sqm
View : <https://www.kennedyandhunt.com.au/sale/vic/macedon-ranges/bullengarook/residential/acreagesemirural/5848706>

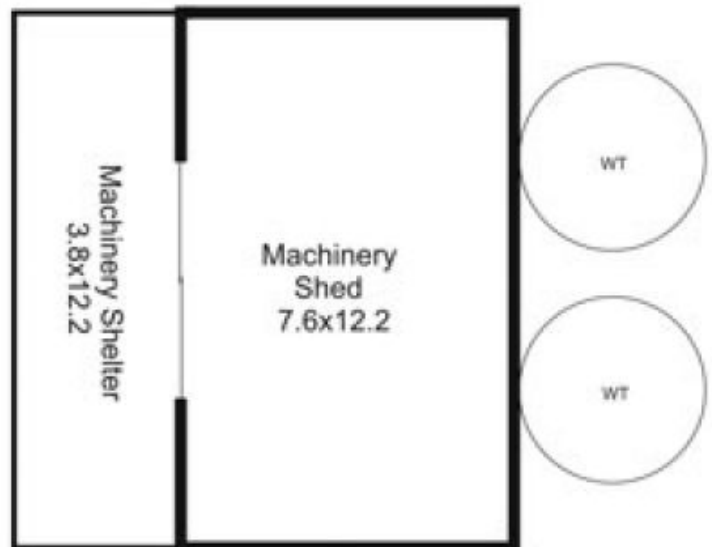
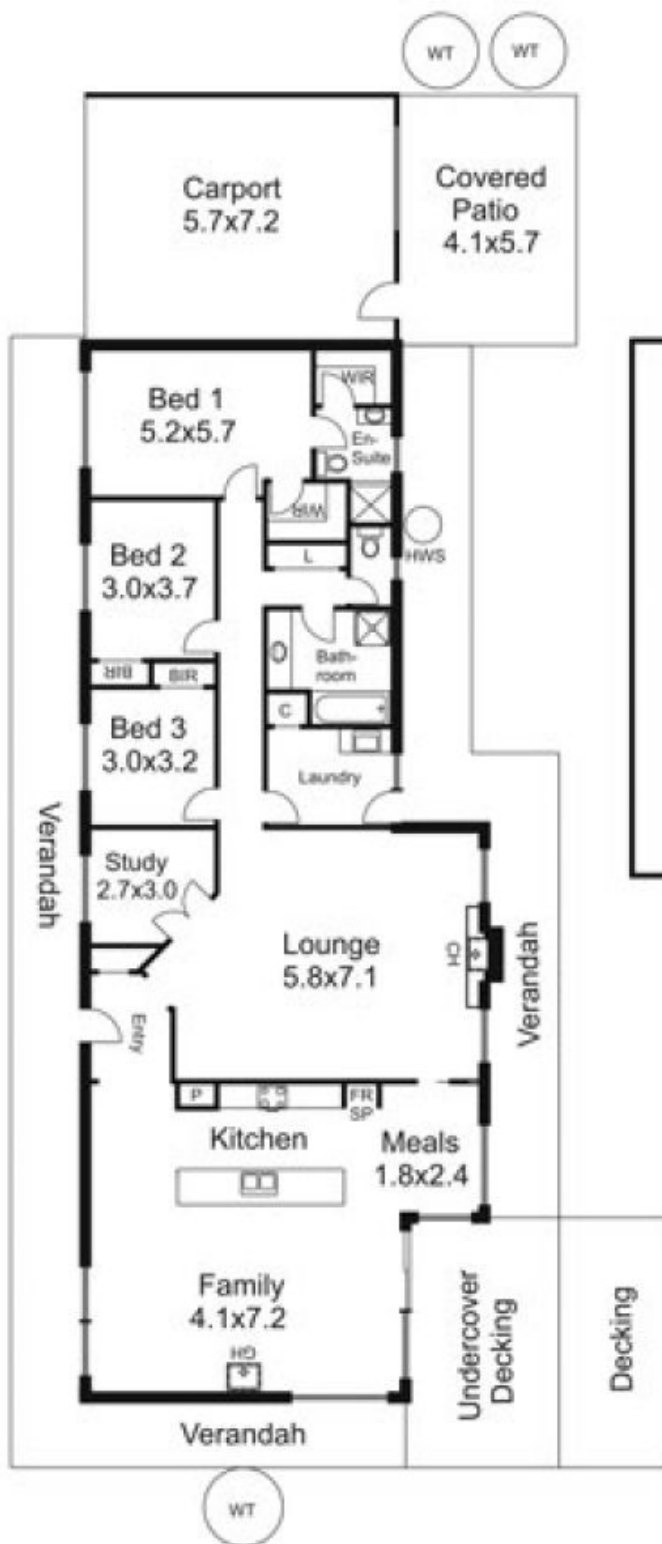

Note: Shed is not in actual position to house



Legend:
 BIR... Built in Robe
 C... Cupboard
 CH... Combustion Heater
 FRSP... Fridge Space
 GH... Gas Heater
 HWS... Hot Water Service
 L... Linen
 P... Pantry
 WIR... Walk in Robe
 WT... Water Tank