



**3 Dalray Crescent NEW GISBORNE VIC**

4 2 3

\*\*\* PRICE REDUCED - OWNER SAYS SELL - ALL OFFERS CONSIDERED \*\*\*

Great opportunity to move into a complete home in a fabulous location! Walking distance to primary school, train station and childcare. Versatile floorplan includes 3 bedrooms, large master bedroom with full Ensuite and walk in robe, study/4th bedroom, formal lounge/dining and spacious open plan kitchen/meals/living area. Other features include quality window furnishings, solar power, ducted heating, split system air conditioner and a wood heater, providing year round comfort and low cost living. Outside there is a large covered pergola overlooking manicured gardens, an oversized garage with rear roller door and mezzanine storage, plus a single carport at the rear of the property perfect for boat or trailer storage. The complete package that will impress the most

**Building Size** : 22 sqm  
**Land Size** : 900 sqm  
**View** : <https://www.kennedyandhunt.com.au/sale/vic/macedon-ranges/new-gisborne/residential/house/5848726>

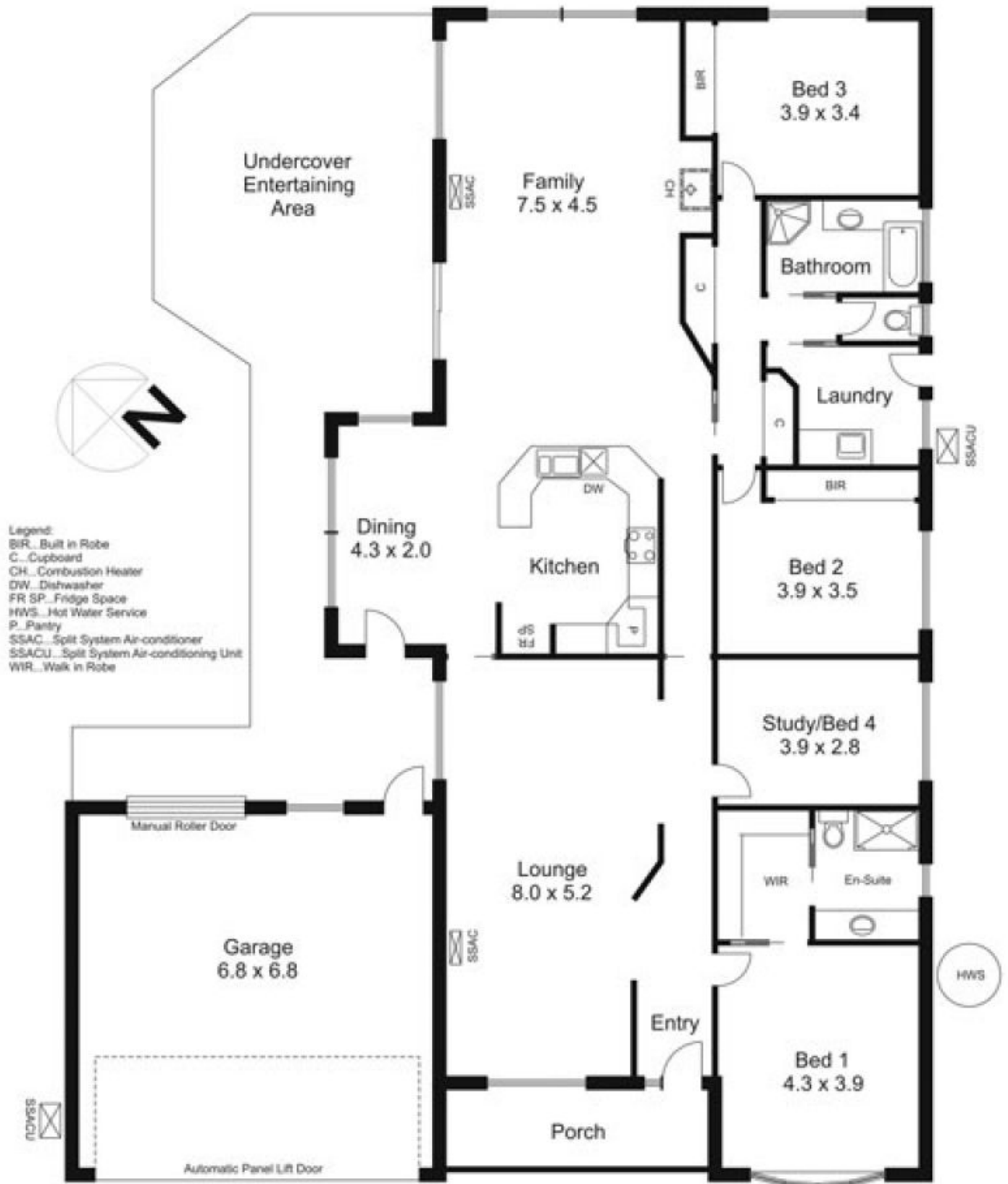

Drawing for illustration purposes only. Not drawn to scale. All measurements are approximate only.