



3 Arwon Court NEW GISBORNE VIC

4 2 2

Absolute privacy and comfort within a few minutes walk to train station, primary schools, recreation facilities & easy access to Calder Freeway. The two storey home has recently been updated and meticulously maintained. Family accommodation is versatile and comprises four bedrooms, study/gallery, three living areas, contemporary light filled kitchen (complete with European stainless steel appliances), ensuite, family bathroom and laundry. Outside offers another world complete covered outdoor entertaining area, several secluded and private garden nooks in which to retreat and relax, a separate workshop/garage (with its own driveway access) and, of course, the integrated double garage. This property is a must see to appreciate.

Building Size : 25 sqm
Land Size : 1335 sqm
View : <https://www.kennedyandhunt.com.au/sale/vic/macedon-ranges/new-gisborne/residential/house/5848808>

Inspection by appointment.



Note.. Not in actual position to house



Upper Level

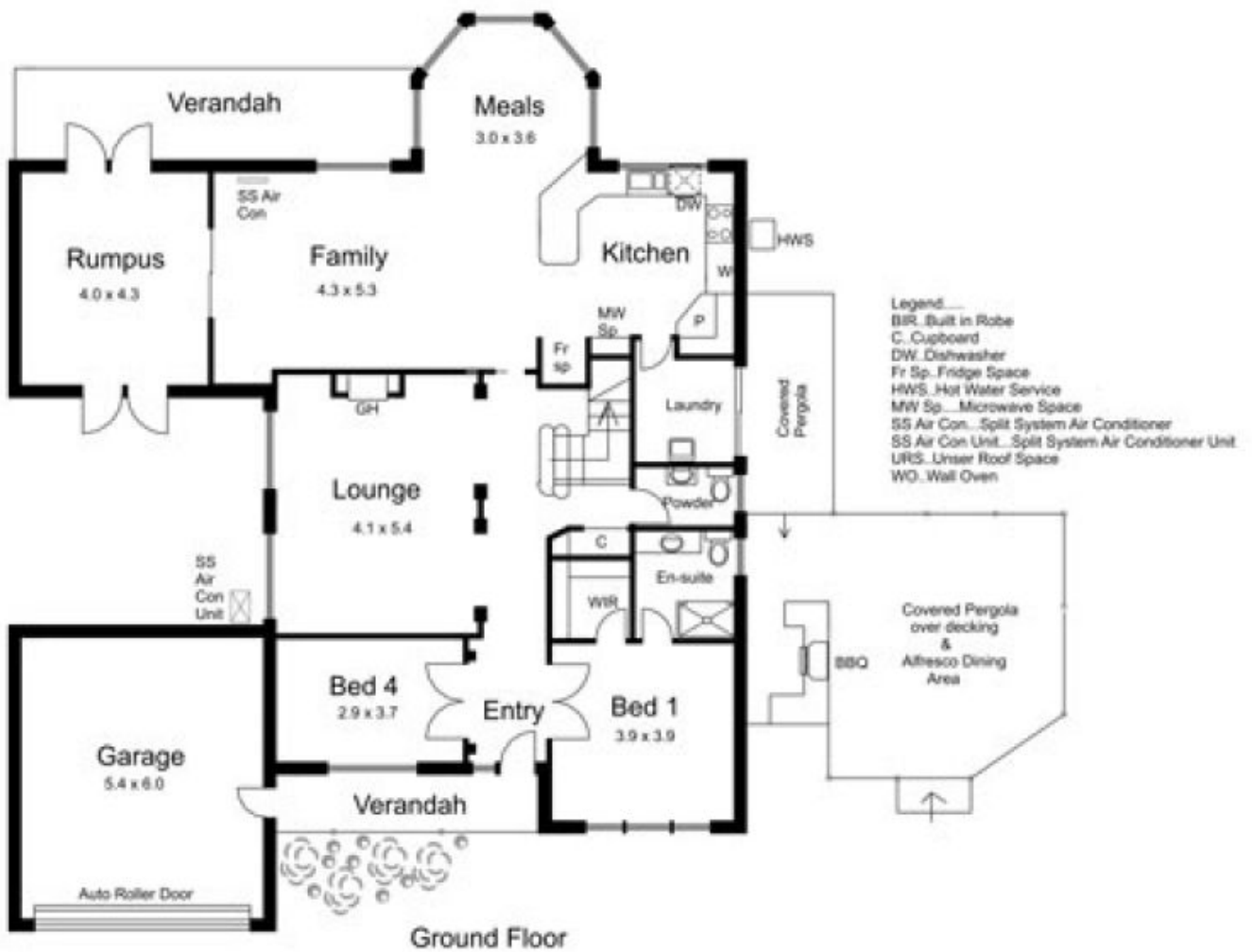

- Legend
- BBR..Built in Robe
 - C..Cupboard
 - DW..Dishwasher
 - Fr Sp..Fridge Space
 - HWS..Hot Water Service
 - MW Sp...Microwave Space
 - SS Air Con...Split System Air Conditioner
 - SS Air Con Unit...Split System Air Conditioner Unit
 - URS..Under Roof Space
 - WO..Wall Oven

Ground Floor

Drawing is for illustration purposes only. Not drawn to scale. All measurements are approximate only.