



## 16 Cooraminta Crescent New Gisborne VIC

3 1 2

Nestled in a breathtaking elevated position on the hills of New Gisborne, 'Avalon' offers tranquil living in a serene environment. This exceptional property boasts panoramic valley and mountain views and provides a picturesque backdrop for your everyday life.

### Setting:

? **Stunning Views:** The home's orientation and large paved terrace capitalize on the property's stunning aspect, offering sweeping views down the valley and across the captivating Macedon Ranges.

? **Privacy:** Set back from the road in a desirable court location, 'Avalon' ensures true privacy for its residents.

**Three-Bedroom Country Residence with Charm and Character:**

? Timber windows perfectly frame the mesmerizing views,

**Price** : Contact Agent  
**Building Size** : 139 sqm  
**Land Size** : 4.1 Acres  
**View** : <https://www.kennedyandhunt.com.au/sale/vic/macedon-ranges/new-gisborne/residential/rural/8069208>



**Jason Kennedy**  
03 5428 2544



Living area = approx 139m<sup>2</sup>

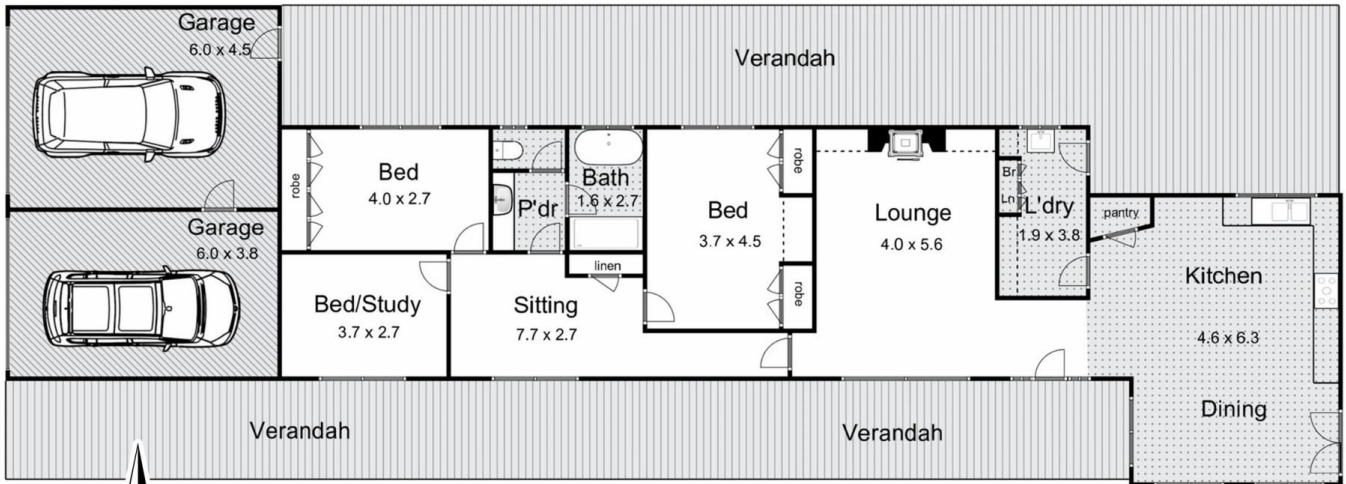

16 Cooraminta Crescent, New Gisborne

N-11  
Kennedy & Hunt

Whilst every attempt has been made to ensure the accuracy of the floor plan contained here, measurements of doors, windows, rooms and any other items are approximate and no responsibility is taken for any error, omission, or mis-statement. This plan is for illustrative purposes only and should be used as such by any prospective purchaser. The services, systems and appliances shown have not been tested and no guarantee as to their operability or efficiency can be given.

open2view.com.au